

DIMENSIONS				
POSITION	A ±0.10	B $^{+0.15}_{-0.05}$	C ±0.20	D ±0.23
36	6	7.65	9.15	25.00
64	20	21.65	23.15	39.00
98	37	38.65	40.15	56.00
164	70	71.65	73.15	89.00

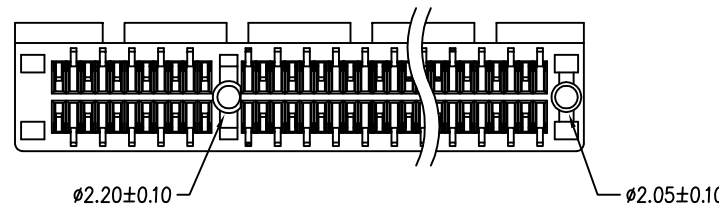
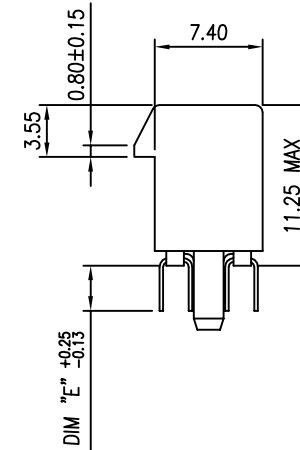
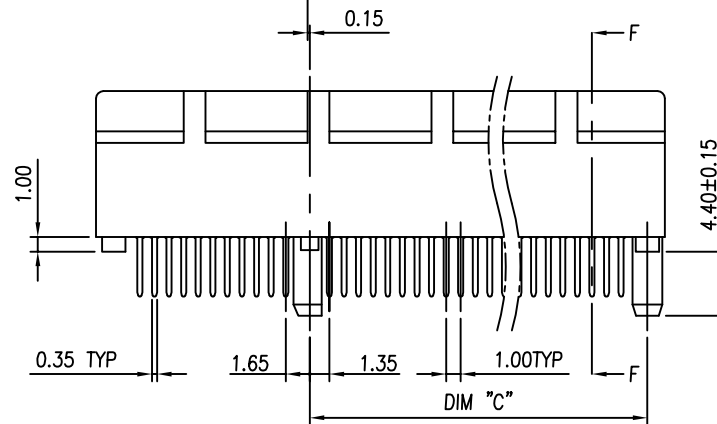
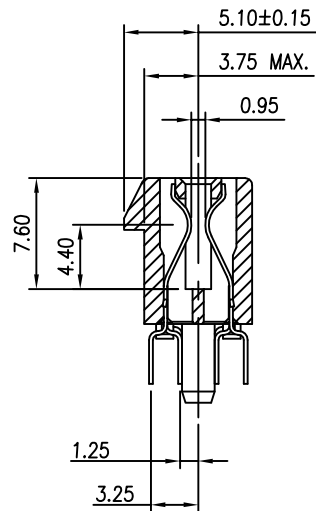
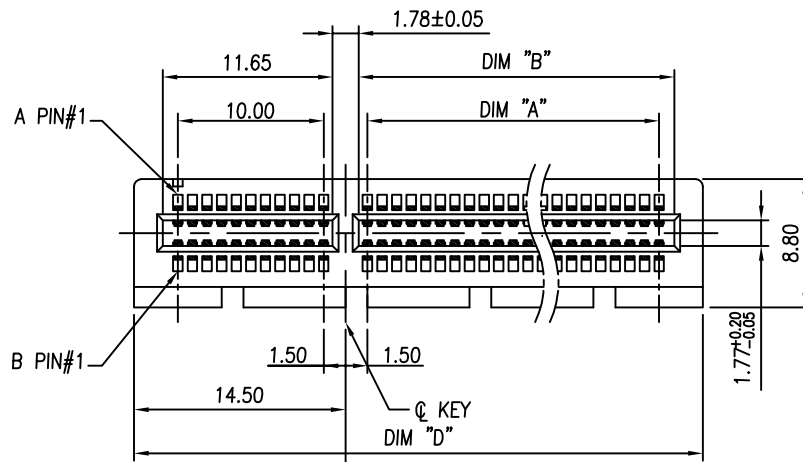

DUAL POST TYPE

				TOLERANCE		UMax conn 东莞市友贸实业有限公司 DONGGUAN UMAXCONN ENTERPRISE LIMITED		TITLE: PCI EXPRESS 1.0mm CARD EDGE ASSY'				
				LINEAR	ANGLES			PART NO. 3183-XXXXXPXT				
B0		Terry	May,11,2011	X.±0.40	X'±	APPD:	John	MAT'L:	DWG NO. 318307001			
B	09026	Terry	Jul,10,2009	.X±0.30	.X'±	CHKD:	Jason	FINISH:	UNITS SCALE SHEET REV			
A	94035	Schumi	Oct,28,2005	.XX±0.20	.XX'±	DRWN:	Schumi	Q'TY:	MM	1 : 1	1 OF 5	B0
REV	ECN NO.	NAME	DATE	.XXX±0.10	.XXX'±							

DIMENSIONS				
POSITION	A ±0.10	B $^{+0.15}_{-0.05}$	C ±0.20	D ±0.23
36	6	7.65	9.15	25.00
64	20	21.65	23.15	39.00
98	37	38.65	40.15	56.00
164	70	71.65	73.15	89.00

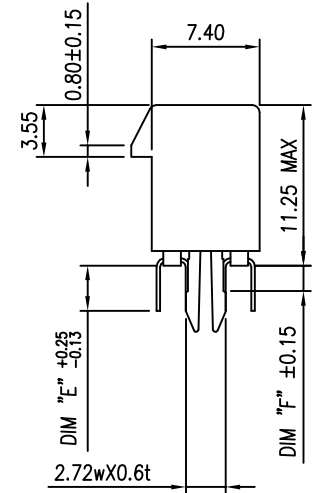
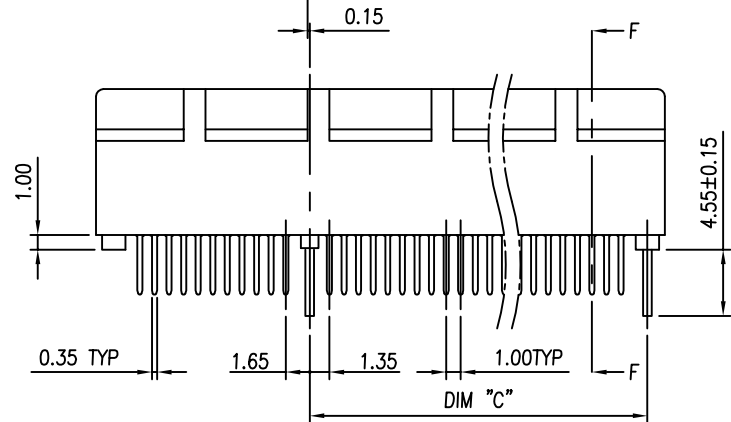
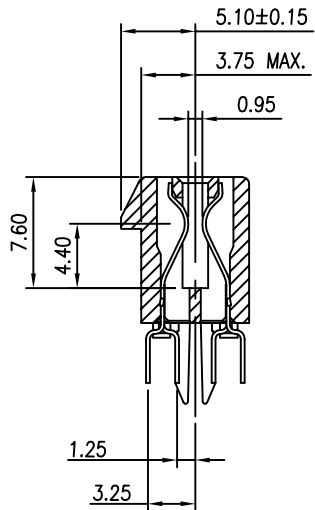
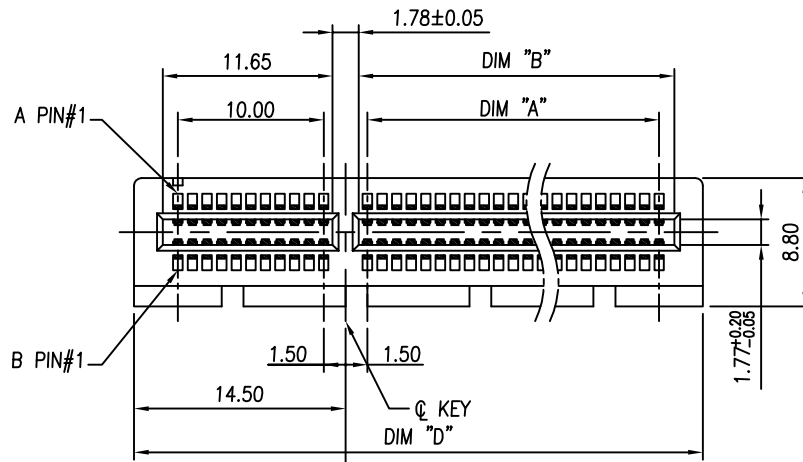

DIM E	PCB THICKNESS	DIM F
2.30	1.56	1.7
3.10	2.36	2.5
2.54	1.56	1.7

CLIP TYPE

REV	See Sheet 1	NAME	DATE
ECN NO.			

TOLERANCE	
LINEAR	ANGLES
X.±0.40	X°.±
.X±0.30	.X°.±
.XX±0.20	.XX°.±
.XXX±0.10	.XXX°.±

UMax conn 东莞市友贸实业有限公司
DONGGUAN UMAXCONN ENTERPRISE LIMITED

APPD: Jason MAT'L:
CHKD: Schumi FINISH:
DRWN: Schumi Q'TY:

TITLE: PCI EXPRESS 1.0mm CARD EDGE ASSY'

PART NO. 3183-XXXXXPXT

DWG NO. 318307001

UNITS	SCALE	SHEET	REV
MM	1 : 1	2 OF 5	B0

DIMENSIONS			
POSITION	A ± 0.10	B $\begin{smallmatrix} +0.15 \\ -0.05 \end{smallmatrix}$	D ± 0.23
36	6	7.65	25.00
64	20	21.65	39.00
98	37	38.65	56.00
164	70	71.65	89.00

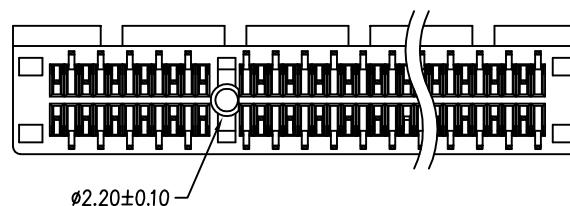
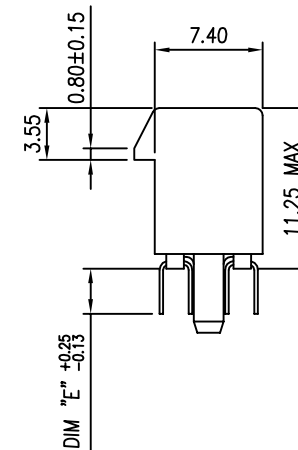
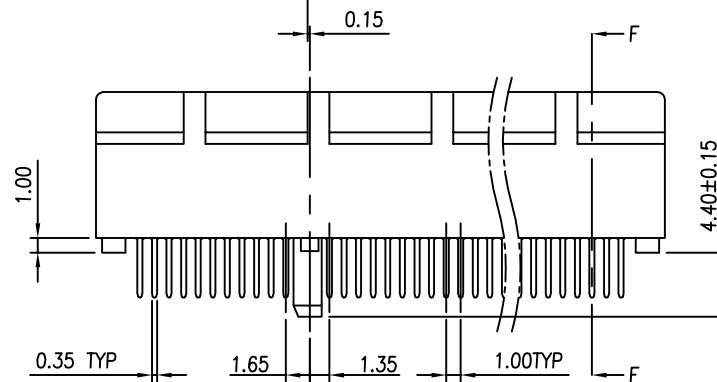
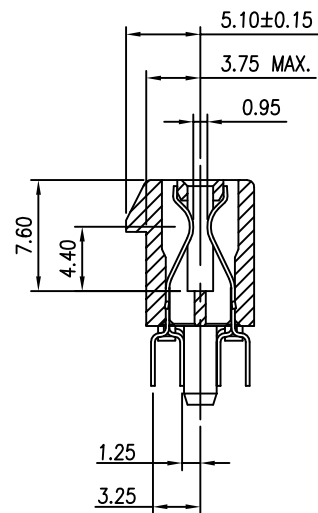
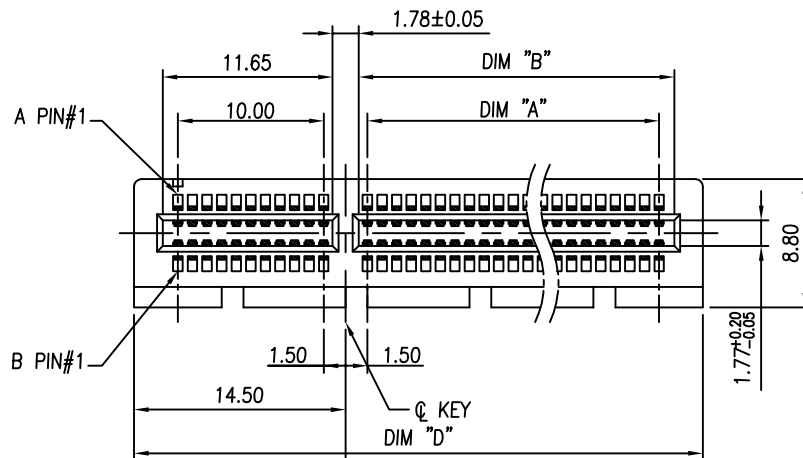

SINGLE POST TYPE

TOLERANCE		UMax conn 东莞市友贸实业有限公司 DONGGUAN UMAXCONN ENTERPRISE LIMITED	TITLE:	
LINEAR	ANGLES		PCI EXPRESS 1.0mm CARD EDGE ASSY'	
X.±0.40	X'±	APPD: Jason	MAT'L:	PART NO. 3183-XXXXPXT
.X±0.30	.X'±			DWG NO. 318307001
.XX±0.20	.XX'±	CHKD: Schumi	FINISH:	UNITS SCALE SHEET REV MM 1 : 1 3 OF 5 B0
.XXX±0.10	.XXX'±	DRWN: Schumi	Q'TY:	

See Sheet 1			
REV	ECN NO.	NAME	DATE

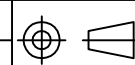

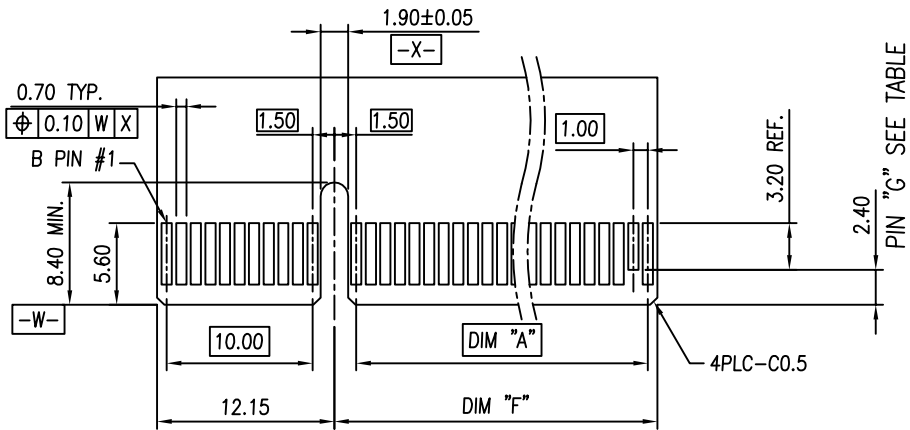

I/O PANEL DIRECTION
PRIMARY (COMPONENT) SIDE

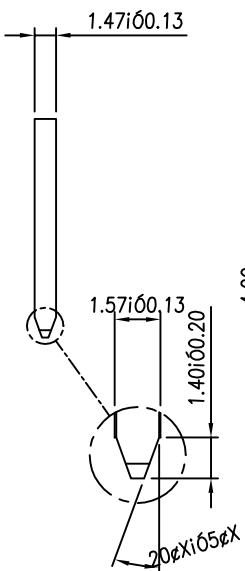

I/O PANEL DIRECTION
SECONDARY (SOLDER) SIDE
ADD-IN CARD EDGE-FINGER DIMENSIONS

DIMENSIONS				
POSITION	A	C	F ±0.20	G
36	6	9.15	8.15	B PIN#17
64	20	23.15	22.15	B PIN#31
98	37	40.15	39.15	B PIN#48
164	70	73.15	72.15	B PIN#81

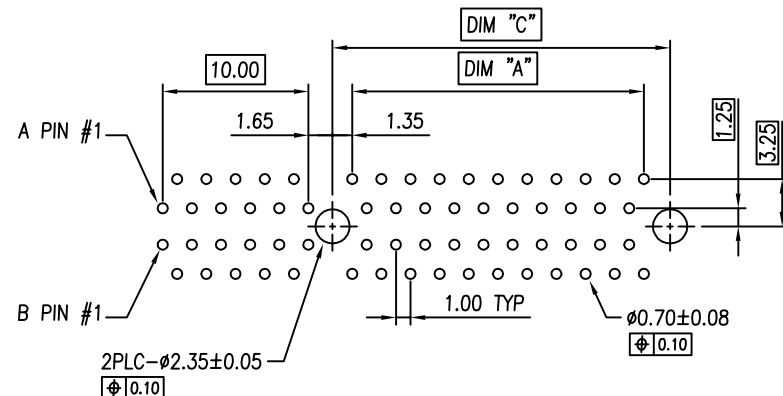

RECOMMENDED PCB LAYOUT
POST TYPE & CLIP TYPE

TOLERANCE: ±0.05

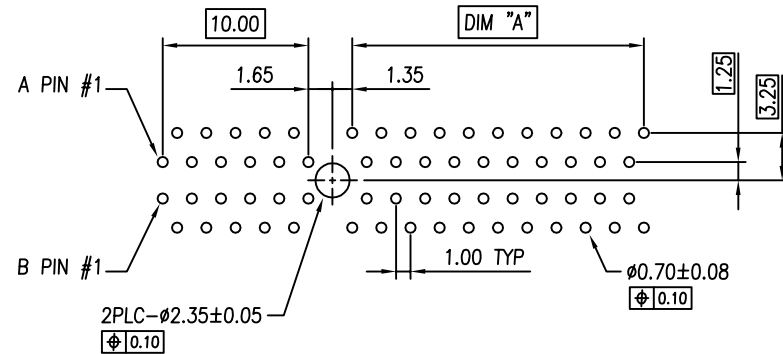

RECOMMENDED PCB LAYOUT
SINGLE POST TYPE

TOLERANCE: ±0.05

TOLERANCE	
LINEAR	ANGLES
X.	X'±
.X	.X'±
.XX	.XX'±
.XXX	.XXX'±

UMax conn 东莞市友贸实业有限公司
DONGGUAN UMAXCONN ENTERPRISE LIMITED

TITLE: PCI EXPRESS 1.0mm
CARD EDGE ASSY'

PART NO. 3183-XXXXXPXT

DWG NO. 318307001

APPD: Jason MAT'L:
CHKD: Schumi FINISH:
DRWN: Schumi Q'TY:

UNITS	SCALE	SHEET	REV
MM	1 : 1	4 OF 5	B0

REV	ECN NO.	NAME	DATE
	See Sheet 1		

NOTES:

1. MATERIAL:

1.1 HOUSING: THERMOPLASTIC, HIGH TEMP.,
UL94V-0;
COLOR: SEE PART NO..

1.2 CONTACTS: COPPER ALLOY.

1.3 CLIP: COPPER ALLOY.

2. FINISH:

2.1 CONTACT:

SELECTEIVE GOLD PLATING ON CONTACT AREA.
100μ" MIN. MATTE TIN PLATING ON SOLDER TAILS,
50μ" MIN. NICKEL UNDERPLATING OVERALL.

2.2 CLIP:

100μ" MIN. MATTE-TIN OVER 50u" MIN NICKEL PLATING.

3. PRODUCT SPEC.: PS-3GIO-01

4. PACKING SPEC.: 318304001

PART NO.

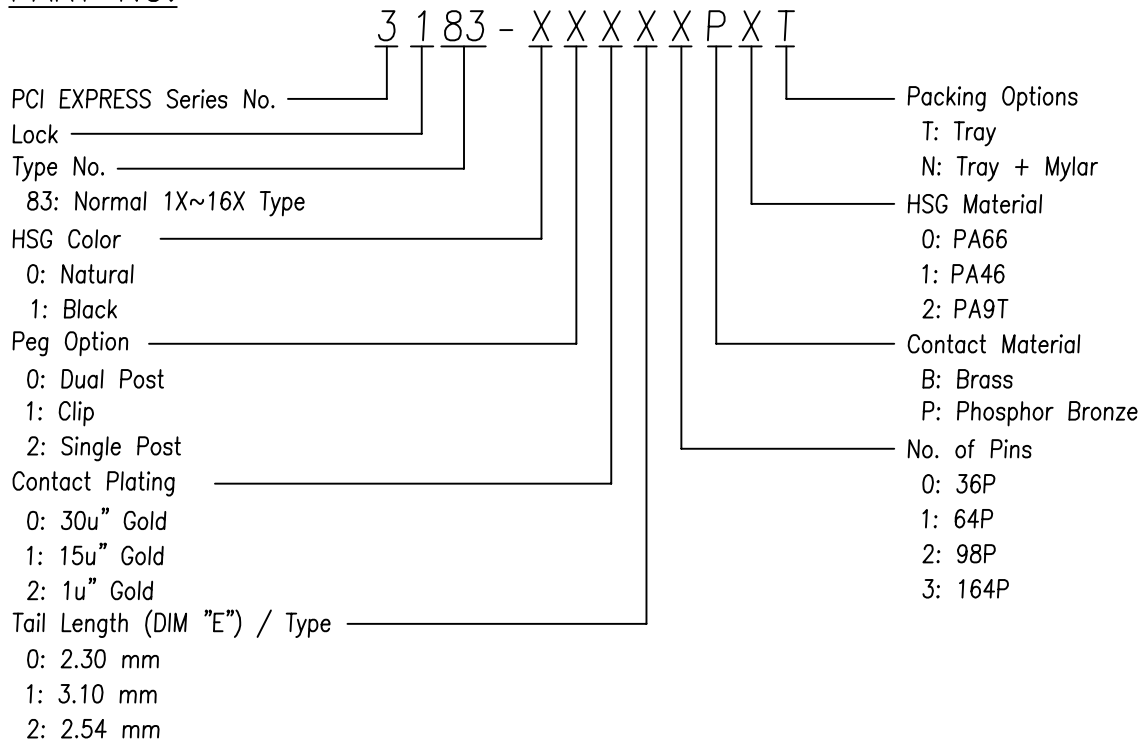

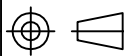
TOLERANCE		UMax conn 东莞市友贸实业有限公司 DONGGUAN UMAXCONN ENTERPRISE LIMITED	TITLE: PCI EXPRESS 1.0mm CARD EDGE ASSY'											
LINEAR	ANGLES		PART NO. 3183-XXXXXPXT											
X.	X'±	APPD: Jason	MAT'L:			DWG NO. 318307001								
.X	.X'±	CHKD: Schumi	FINISH:			 <table border="1"> <tr> <td>UNITS</td> <td>SCALE</td> <td>SHEET</td> <td>REV</td> </tr> <tr> <td>MM</td> <td>1 : 1</td> <td>5 OF 5</td> <td>B0</td> </tr> </table>	UNITS	SCALE	SHEET	REV	MM	1 : 1	5 OF 5	B0
UNITS	SCALE	SHEET	REV											
MM	1 : 1	5 OF 5	B0											
.XX	.XX'±	DRWN: Schumi	Q'TY:											
.XXX	.XXX'±													

See Sheet 1			
REV	ECN NO.	NAME	DATE