

### Specifications

Current Rating: 1A~3A AC,DC(Per Pin)  
 Voltage Rating: 250V AC,DC(Per Pin)  
 Temperature Range: -25°C ~ +85°C  
 Contact Resistance: 10mΩ Max.  
 Insulation Resistance: 1000MΩ Min.  
 Withstanding Voltage: 800V AC/minute  
 \*Contact H.R for Details\*

**A**  
**B**  
**C**  
**F**

### Standards



E179987

### Ordering Code

① ② ③ ④ ⑤  
**A2004** - **X** **X** **X** - **X**

- ① Series No.
- ② Plating Code: T=Tin-Plated, G=Gold-Plated, M=Matte Tin-Plated
- ③ Material: P=Phosphor Bronze
- ④ E=Stamping Before Plating
- ⑤ Option Code: (Refer to Drawings)

① ② ③ ④ ⑤  
**A2004** **XX** **X** - **2X** **NP**

- ① Series No.
- ② Connector Type: WV=Vertical, WR=Right Angle
- ③ Blank=Normal Type, A=A Type, B=B Type, C=C Type, D=D Type
- ④ 2X=Dual Row
- ⑤ No. of Circuits

① ② ③ ④ ⑤  
**A2004** **X** **X** - **2X** **NP**

- ① Series No.
- ② Housing Type: H=Housing
- ③ Blank=Normal Type, A=A Type, B=B Type, D=D Type
- ④ 2X=Dual Row
- ⑤ No. of Circuits



### Assembly Layout

A  
B  
C  
F

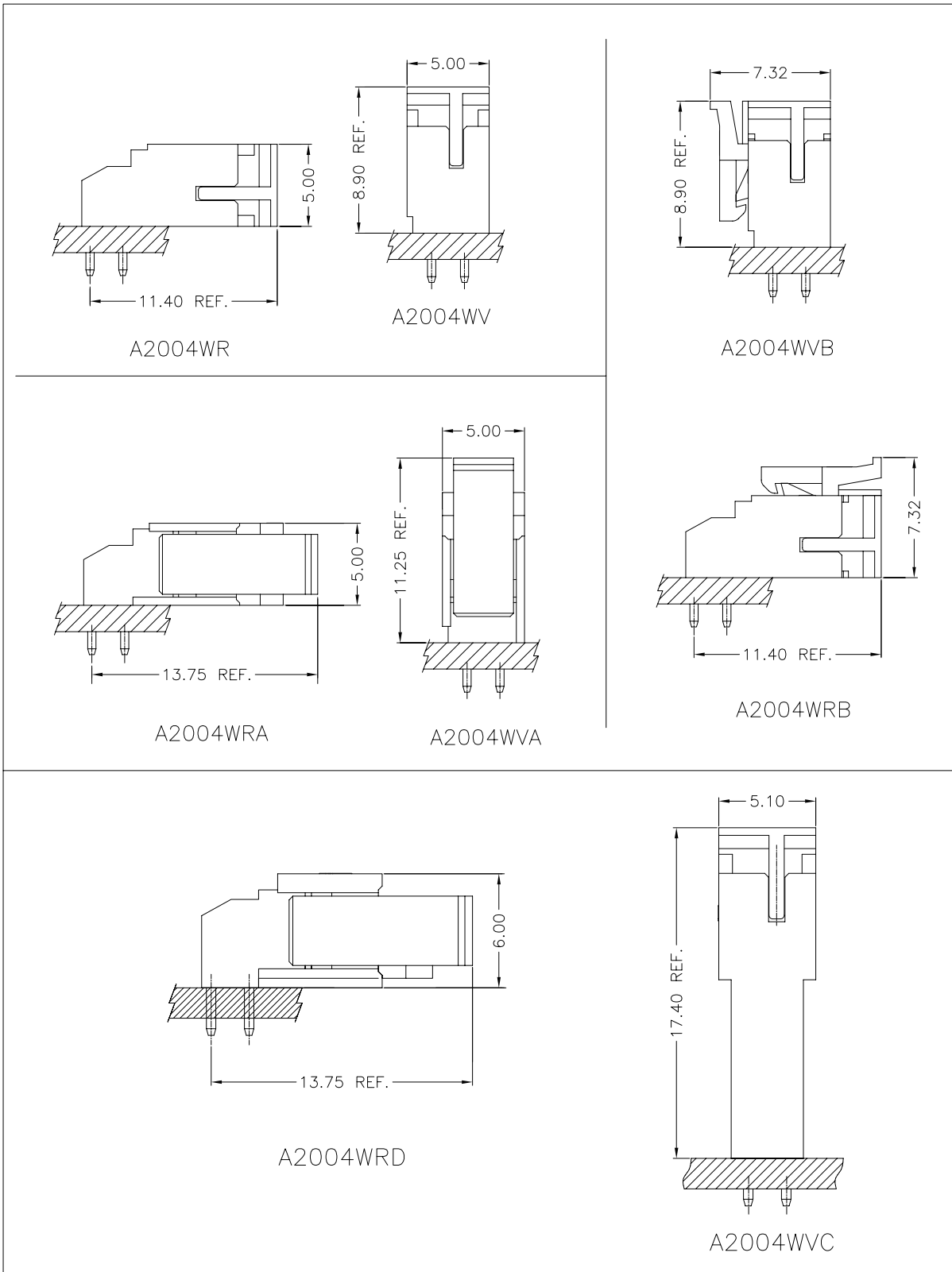



### A2004-XXX

2.00mm Pitch Crimp Terminal

#### Reference Information:

\*Used in H.R A2004H,A2004HA Series Dual Row Housing

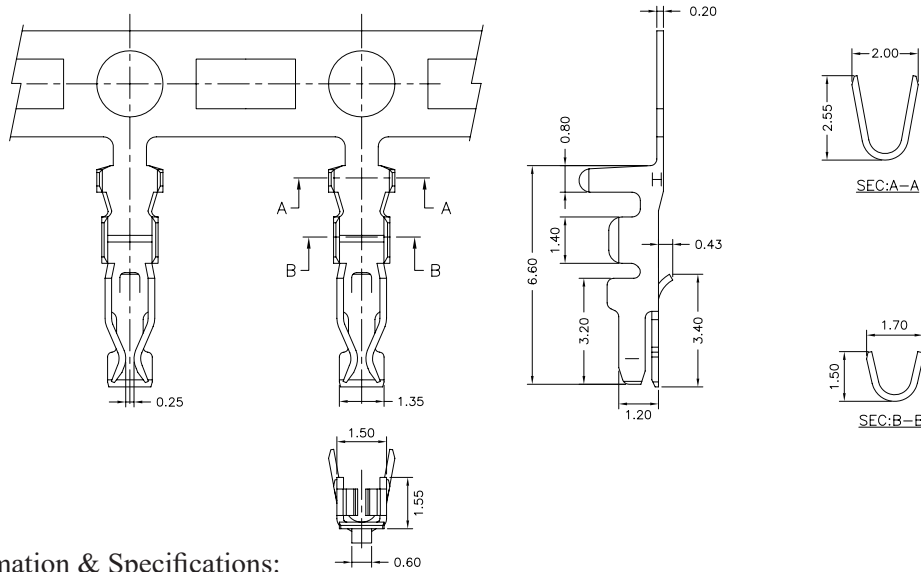

Ordering Information & Specifications:

Unit:mm

Part No.	Wire Range	Insulation O.D.	Material	Finish	Qty/Reel
A2004-TPE	AWG#22-#28	1.50mm(Max)	Phosphor Bronze	Tin-Plated	10,000Pcs
A2004-GPE	AWG#22-#28	1.50mm(Max)	Phosphor Bronze	Gold-Plated	10,000Pcs
A2004-MPE	AWG#22-#28	1.50mm(Max)	Phosphor Bronze	Matte-Tin-Plated	10,000Pcs

Note:E-Stamping Before Plating

### A2004-XXX

2.00mm Pitch Crimp Terminal

#### Reference Information:

\*Used in H.R A2004H,A2004HA Series Dual Row Housing

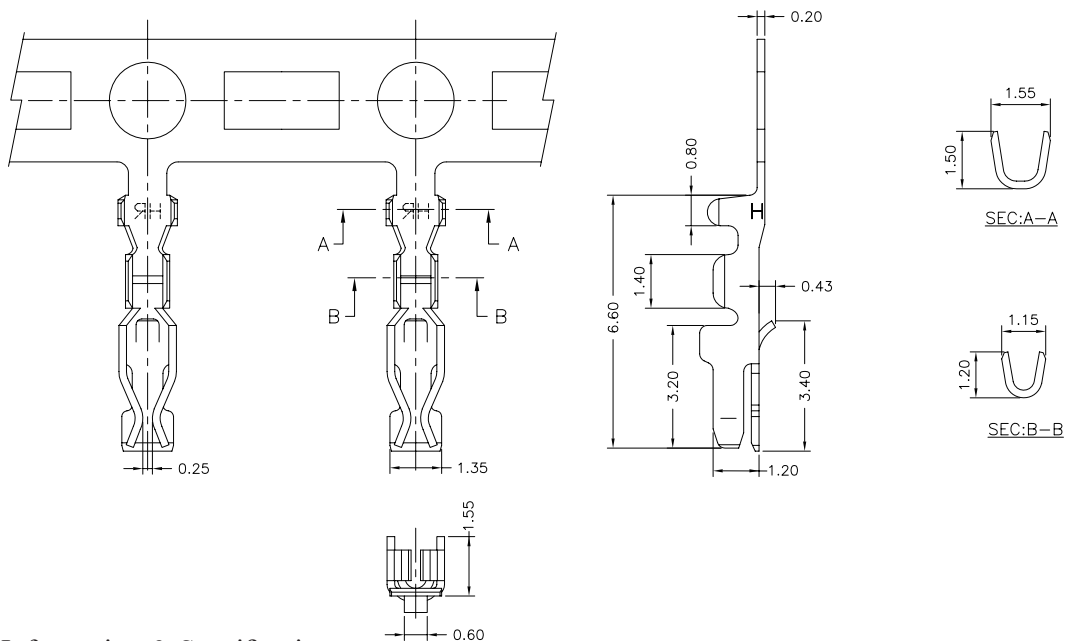

Ordering Information & Specifications:

Unit:mm

Part No.	Wire Range	Insulation O.D.	Material	Finish	Qty/Reel
A2004-TPE-L	AWG#28-#32	0.90mm(Max)	Phosphor Bronze	Tin-Plated	10,000Pcs

Note:E-Stamping Before Plating

A  
B  
C  
F



# A2004 SERIES

2.00mm Pitch Wire to Board Connector

## A2004H-2 — 2.00mm Pitch Dual Row Housing

### Reference Information:

- \*Material: Thermoplastic
- \*Suitable H.R A2004 Series Terminal
- \*Mates with H.R A2004WV, A2004WR Series Dual Row Wafer

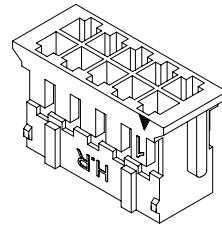

Dimensions:

Circuit No.	Dimensions	
	A	B
2X02	2.00	5.90
2X03	4.00	7.90
2X04	6.00	9.90
2X05	8.00	11.90
2X06	10.00	13.90
2X07	12.00	15.90
2X08	14.00	17.90
2X09	16.00	19.90
2X10	18.00	21.90
2X11	20.00	23.90
2X12	22.00	25.90
2X13	24.00	27.90
2X14	26.00	29.90
2X15	28.00	31.90
2X16	30.00	33.90
2X17	32.00	35.90
2X18	34.00	37.90
2X19	36.00	39.90
2X20	38.00	41.90
2X21	40.00	43.90
2X22	42.00	45.90
2X23	44.00	47.90
2X24	46.00	49.90

Unit:mm

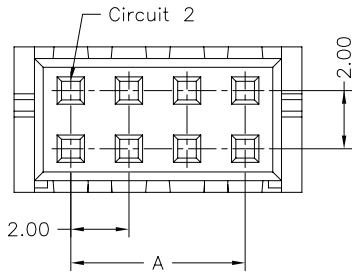

A2004H-2XNP X X X XX X XX X

① ② ③ ④ ⑤ ⑥ ⑦

- ① Halogen Free or Not
- ② Material
- ③ Color
- ④ Plating Code for Contacts
- ⑤ Plating Code
- ⑥ Option Code
- ⑦ Packing Code

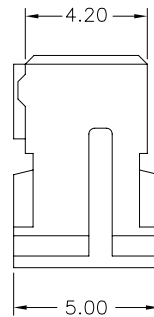
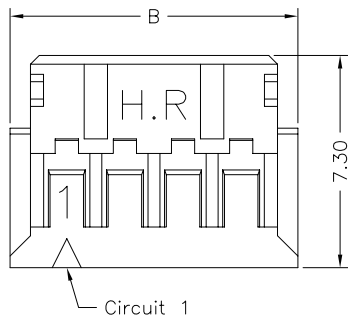

## A2004WV-2 — 2.00mm Pitch 180° Dual Row Wafer

### Reference Information:

- \*Material: Pin: Copper Alloy  
Wafer: Thermoplastic
- \*Mates with H.R A2004H Series Dual Row Housing

Dimensions:

Circuit No.	Dimensions	
	A	B
2X02	2.00	6.00
2X03	4.00	8.00
2X04	6.00	10.00
2X05	8.00	12.00
2X06	10.00	14.00
2X07	12.00	16.00
2X08	14.00	18.00
2X09	16.00	20.00
2X10	18.00	22.00
2X11	20.00	24.00
2X12	22.00	26.00
2X13	24.00	28.00
2X14	26.00	30.00
2X15	28.00	32.00
2X16	30.00	34.00
2X17	32.00	36.00
2X18	34.00	38.00
2X19	36.00	40.00
2X20	38.00	42.00
2X21	40.00	44.00
2X22	42.00	46.00
2X23	44.00	48.00
2X24	46.00	50.00

Unit:mm

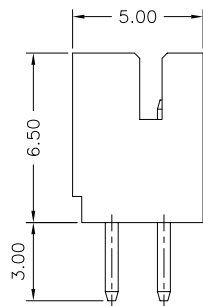
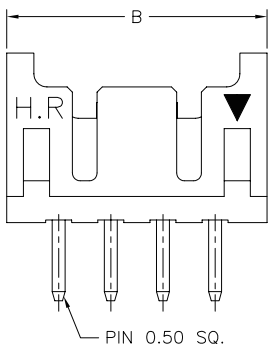
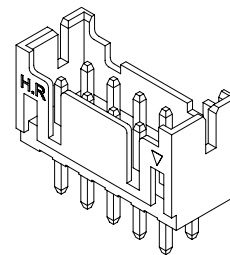
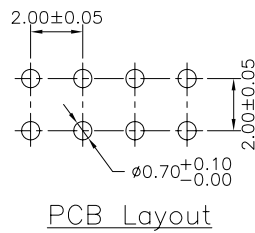
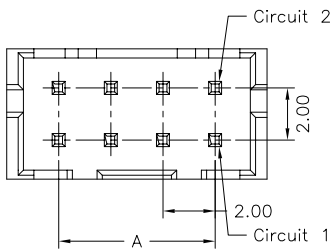

A2004WV-2XNP X X X XX X XX X

① ② ③ ④ ⑤ ⑥ ⑦

- ① Halogen Free or Not
- ② Material
- ③ Color
- ④ Plating Code for Contacts
- ⑤ Plating Code
- ⑥ Option Code
- ⑦ Packing Code



# A2004 SERIES

2.00mm Pitch Wire to Board Connector

## A2004WR-2

2.00mm Pitch 90° Dual Row Wafer

### Reference Information:

\*Material: Pin: Copper Alloy

Wafer: Thermoplastic

\*Mates with H.R A2004H Series Dual Row Housing

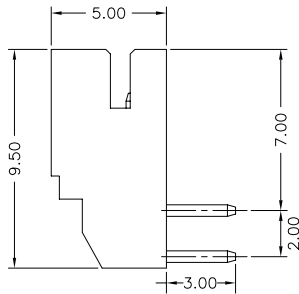
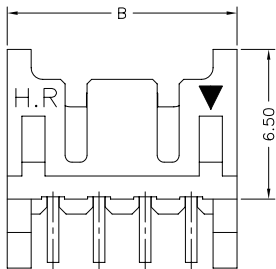
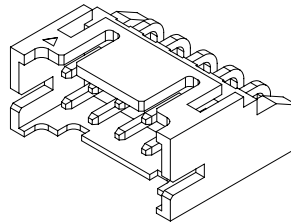
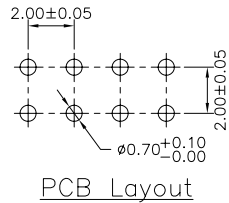
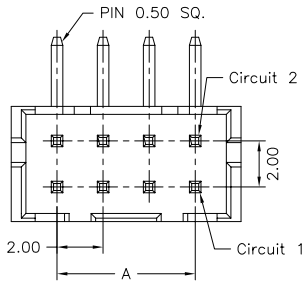

A2004WR-2XNP X X X XX X XX X

① ② ③ ④ ⑤ ⑥ ⑦

- ① Halogen Free or Not
- ② Material
- ③ Color
- ④ Plating Code for Contacts
- ⑤ Plating Code
- ⑥ Option Code
- ⑦ Packing Code

Dimensions:

Circuit No.	Dimensions	
	A	B
2X02	2.00	6.00
2X03	4.00	8.00
2X04	6.00	10.00
2X05	8.00	12.00
2X06	10.00	14.00
2X07	12.00	16.00
2X08	14.00	18.00
2X09	16.00	20.00
2X10	18.00	22.00
2X11	20.00	24.00
2X12	22.00	26.00
2X13	24.00	28.00
2X14	26.00	30.00
2X15	28.00	32.00
2X16	30.00	34.00
2X17	32.00	36.00
2X18	34.00	38.00
2X19	36.00	40.00
2X20	38.00	42.00

Unit:mm

A  
B  
C  
F

## A2004HA-2

2.00mm Pitch Dual Row Housing

### Reference Information:

\*Material: Thermoplastic

\*Suitable H.R A2004 Series Terminal

\*Mates with H.R A2004WVA, A2004WRA Series Dual Row Wafer

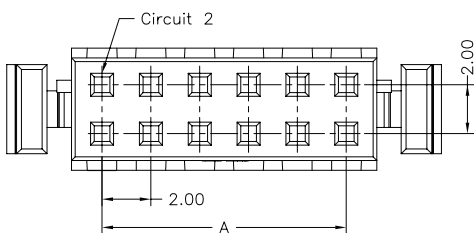
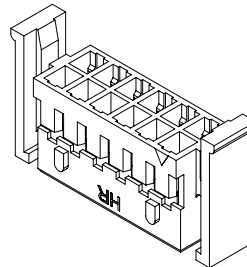

A2004HA-2XNP X X X XX X XX X

① ② ③ ④ ⑤ ⑥ ⑦

- ① Halogen Free or Not
- ② Material
- ③ Color
- ④ Plating Code for Contacts
- ⑤ Plating Code
- ⑥ Option Code
- ⑦ Packing Code

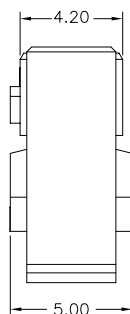
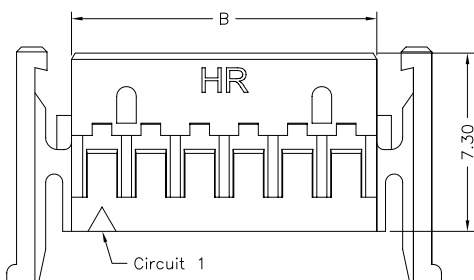

Dimensions:

Circuit No.	Dimensions	
	A	B
2X02	2.00	4.50
2X03	4.00	6.50
2X04	6.00	8.50
2X05	8.00	10.50
2X06	10.00	12.50
2X07	12.00	14.50
2X08	14.00	16.50
2X09	16.00	18.50
2X10	18.00	20.50
2X11	20.00	22.50
2X12	22.00	24.50
2X13	24.00	26.50
2X14	26.00	28.50
2X15	28.00	30.50
2X16	30.00	32.50
2X17	32.00	34.50
2X18	34.00	36.50
2X19	36.00	38.50
2X20	38.00	40.50
2X22	42.00	44.50

Unit:mm



# A2004 SERIES

2.00mm Pitch Wire to Board Connector

## A2004WVA-2

2.00mm Pitch 180° Dual Row Wafer

### Reference Information:

- \*Material: Pin: Copper Alloy  
Wafer: Thermoplastic
- \*Mates with H.R A2004HA Series Dual Row Housing

Dimensions:

Circuit No.	Dimensions	
	A	B
2X02	2.00	8.00
2X03	4.00	10.00
2X04	6.00	12.00
2X05	8.00	14.00
2X06	10.00	16.00
2X07	12.00	18.00
2X08	14.00	20.00
2X09	16.00	22.00
2X10	18.00	24.00
2X11	20.00	26.00
2X12	22.00	28.00
2X13	24.00	30.00
2X14	26.00	32.00
2X15	28.00	34.00
2X16	30.00	36.00
2X17	32.00	38.00
2X18	34.00	40.00
2X19	36.00	42.00
2X20	38.00	44.00
2X22	42.00	48.00

Unit:mm

A  
B  
C  
F

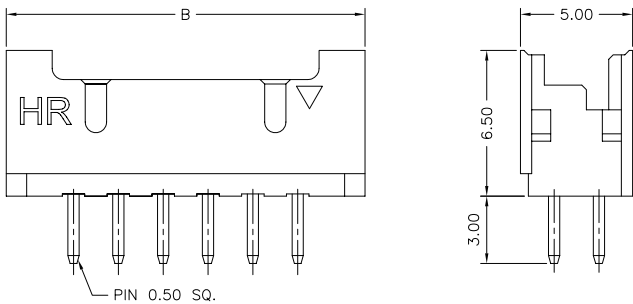
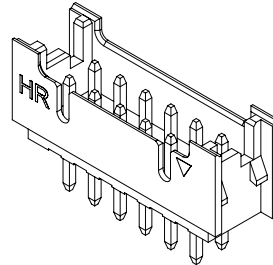
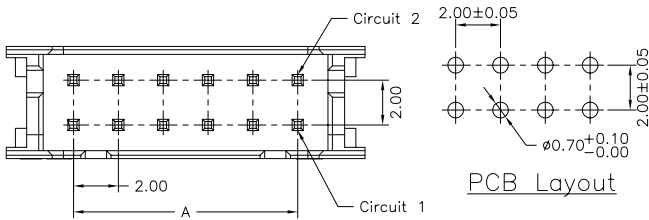

A2004WVA-2XNP	X	X	X	XX	X	XX	X
	①	②	③	④	⑤	⑥	⑦
①	Halogen Free or Not						
②	Material						
③	Color						
④	Plating Code for Contacts						
⑤	Plating Code						
⑥	Option Code						
⑦	Packing Code						

## A2004WRA-2

2.00mm Pitch 90° Dual Row Wafer

### Reference Information:

- \*Material: Pin: Copper Alloy  
Wafer: Thermoplastic
- \*Mates with H.R A2004HA Series Dual Row Housing

Dimensions:

Circuit No.	Dimensions	
	A	B
2X02	2.00	8.00
2X03	4.00	10.00
2X04	6.00	12.00
2X05	8.00	14.00
2X06	10.00	16.00
2X07	12.00	18.00
2X08	14.00	20.00
2X09	16.00	22.00
2X10	18.00	24.00
2X11	20.00	26.00
2X12	22.00	28.00
2X13	24.00	30.00
2X14	26.00	32.00
2X15	28.00	34.00
2X16	30.00	36.00
2X17	32.00	38.00
2X18	34.00	40.00
2X19	36.00	42.00
2X20	38.00	44.00

Unit:mm

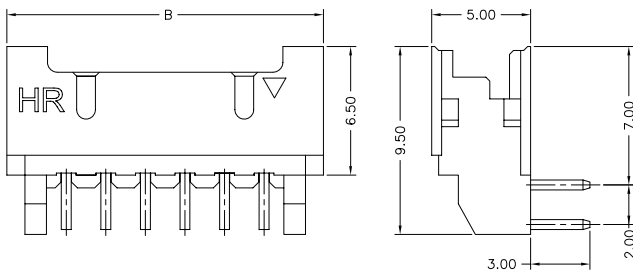
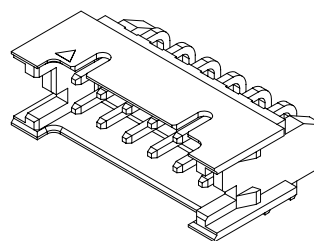
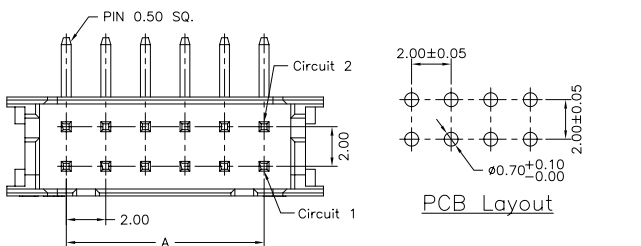

A2004WRA-2XNP	X	X	X	XX	X	XX	X
	①	②	③	④	⑤	⑥	⑦
①	Halogen Free or Not						
②	Material						
③	Color						
④	Plating Code for Contacts						
⑤	Plating Code						
⑥	Option Code						
⑦	Packing Code						



### A2004-XXX

2.00mm Pitch Crimp Terminal

#### Reference Information:

\*Used in H.R A2004HB Series Dual Row Housing

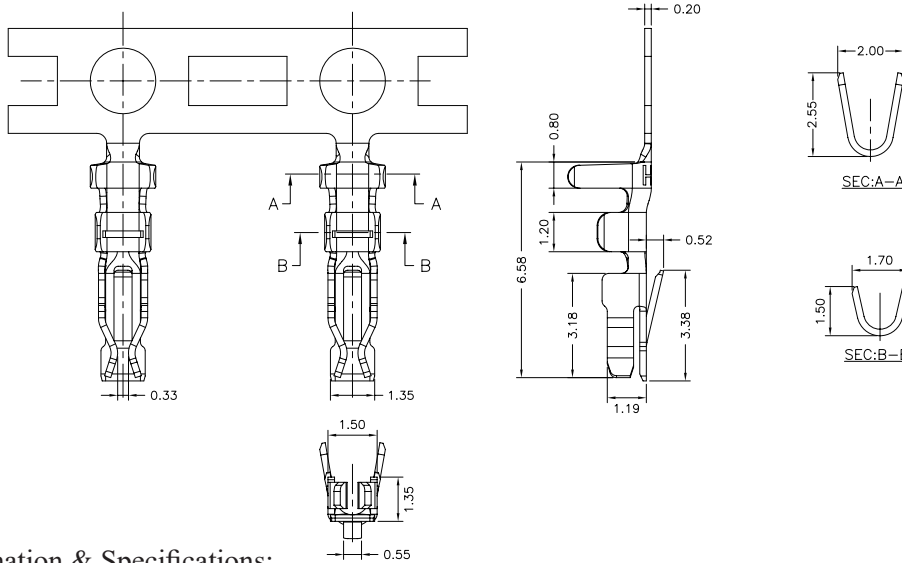

Ordering Information & Specifications:

Unit:mm

Part No.	Wire Range	Insulation O.D.	Material	Finish	Qty/Reel
A2004-TP-B	AWG#22-#28	1.50mm(Max)	Phosphor Bronze	Tin-Plated	10,000Pcs
A2004-TPE-B	AWG#22-#28	1.50mm(Max)	Phosphor Bronze	Tin-Plated	10,000Pcs
A2004-GPE-B	AWG#22-#28	1.50mm(Max)	Phosphor Bronze	Gold-Plated	10,000Pcs

Note:E-Stamping Before Plating

### A2004-XXX

2.00mm Pitch Crimp Terminal

#### Reference Information:

\*Used in H.R A2004HB Series Dual Row Housing

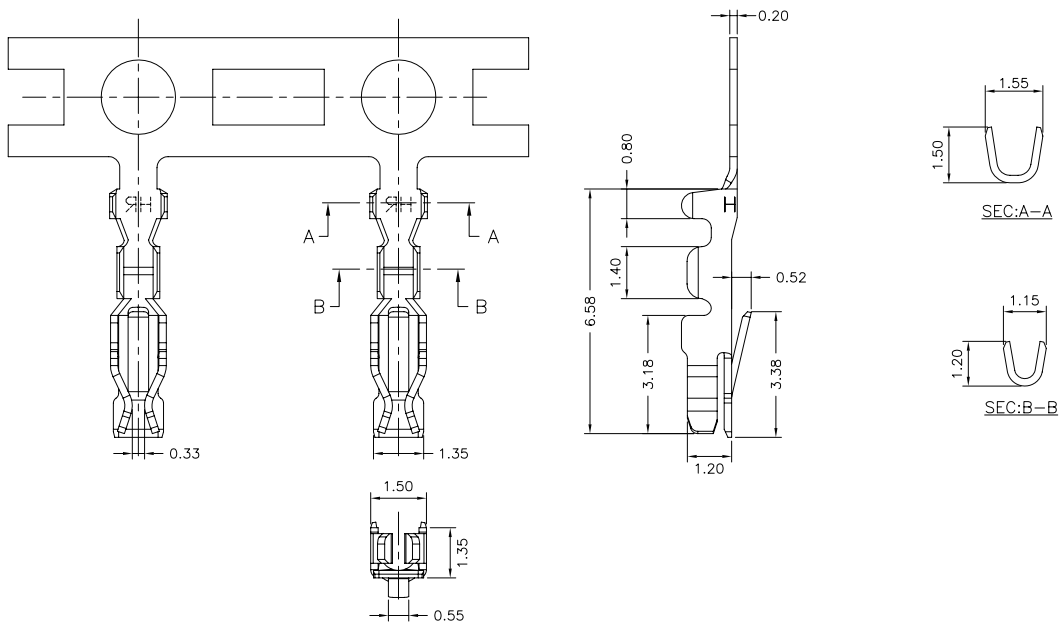

Ordering Information & Specifications:

Unit:mm

Part No.	Wire Range	Insulation O.D.	Material	Finish	Qty/Reel
A2004-TP-LB	AWG#28-#32	0.90mm(Max)	Phosphor Bronze	Tin-Plated	10,000Pcs

Note:E-Stamping Before Plating





### A2004HB-2

2.00mm Pitch Dual Row Housing

#### Reference Information:

- \*Material: Thermoplastic
- \*Suitable H.R A2004 Series Terminal - B Type
- \*Mates with H.R A2004WVB, A2004WRB Series Dual Row Wafer

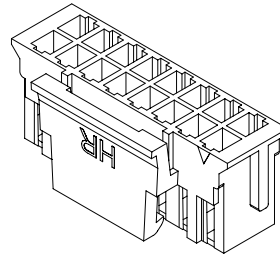

Dimensions:

Circuit No.	Dimensions	
	A	B
2X02	2.00	5.90
2X03	4.00	7.90
2X04	6.00	9.90
2X05	8.00	11.90
2X06	10.00	13.90
2X07	12.00	15.90
2X08	14.00	17.90
2X09	16.00	19.90
2X10	18.00	21.90
2X11	20.00	23.90
2X12	22.00	25.90
2X13	24.00	27.90
2X14	26.00	29.90
2X15	28.00	31.90
2X16	30.00	33.90
2X17	32.00	35.90
2X18	34.00	37.90
2X19	36.00	39.90
2X20	38.00	41.90
2X21	40.00	43.90
2X22	42.00	45.90

Unit:mm

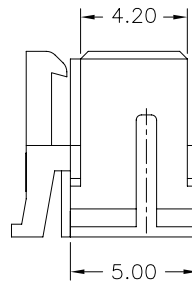
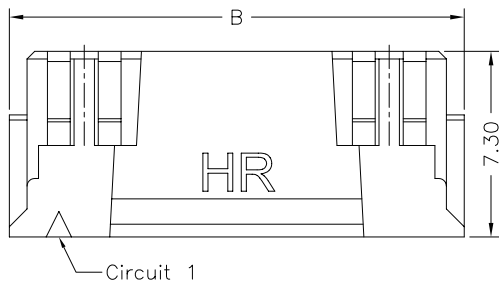
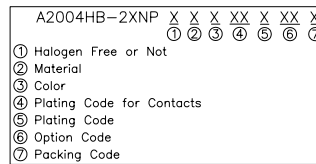
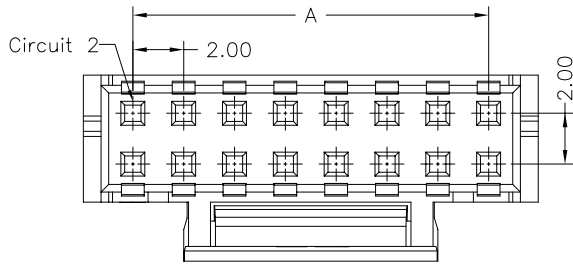

A  
B  
C  
F

### A2004WVB-2

2.00mm Pitch 180° Dual Row Wafer

#### Reference Information:

- \*Material: Pin: Copper Alloy  
Wafer: Thermoplastic
- \*Mates with H.R A2004HB Series Dual Row Housing

Dimensions:

Circuit No.	Dimensions	
	A	B
2X02	2.00	6.00
2X03	4.00	8.00
2X04	6.00	10.00
2X05	8.00	12.00
2X06	10.00	14.00
2X07	12.00	16.00
2X08	14.00	18.00
2X09	16.00	20.00
2X10	18.00	22.00
2X11	20.00	24.00
2X12	22.00	26.00
2X13	24.00	28.00
2X14	26.00	30.00
2X15	28.00	32.00
2X16	30.00	34.00
2X17	32.00	36.00
2X18	34.00	38.00
2X19	36.00	40.00
2X20	38.00	42.00
2X21	40.00	44.00

Unit:mm

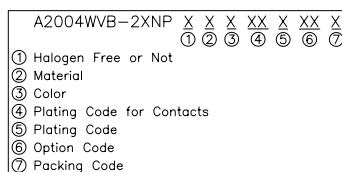
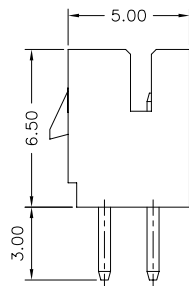
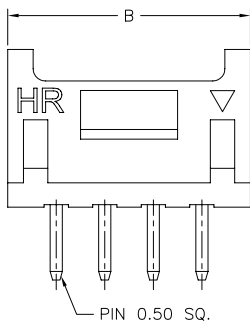
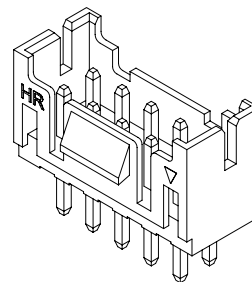
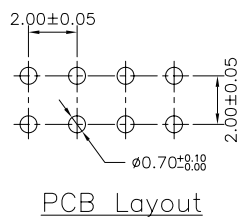
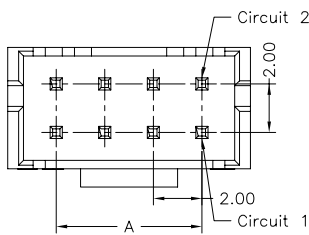





### A2004WRB-2

2.00mm Pitch 90° Dual Row Wafer

#### Reference Information:

\*Material: Pin: Copper Alloy

Wafer: Thermoplastic

\*Mates with H.R A2004HB Series Dual Row Housing

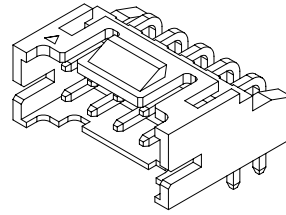

Dimensions:

Circuit No.	Dimensions	
	A	B
2X02	2.00	6.00
2X03	4.00	8.00
2X04	6.00	10.00
2X05	8.00	12.00
2X06	10.00	14.00
2X07	12.00	16.00
2X08	14.00	18.00
2X09	16.00	20.00
2X10	18.00	22.00
2X11	20.00	24.00
2X12	22.00	26.00
2X13	24.00	28.00
2X14	26.00	30.00
2X15	28.00	32.00
2X16	30.00	34.00
2X17	32.00	36.00
2X18	34.00	38.00
2X19	36.00	40.00
2X20	38.00	42.00
2X21	40.00	44.00
2X22	42.00	46.00

Unit:mm

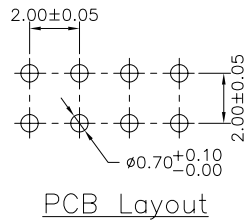
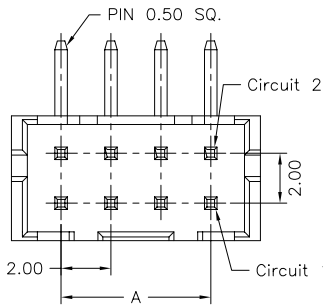

A2004WRB-2XNP X X X XX X XX X

① ② ③ ④ ⑤ ⑥ ⑦

- ① Halogen Free or Not
- ② Material
- ③ Color
- ④ Plating Code for Contacts
- ⑤ Plating Code
- ⑥ Option Code
- ⑦ Packing Code

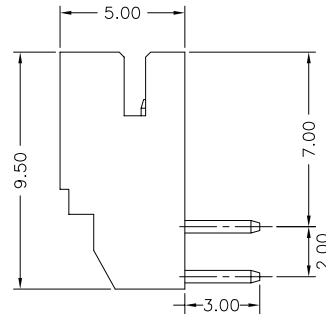
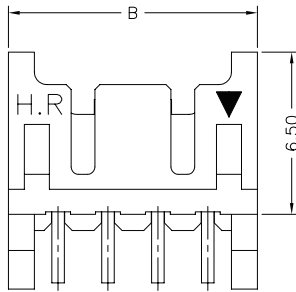

### A2004WVC-2

2.00mm Pitch 180° Dual Row Wafer

#### Reference Information:

\*Material: Pin: Copper Alloy

Wafer: Thermoplastic

\*Mates with H.R A2004H Series Dual Row Housing

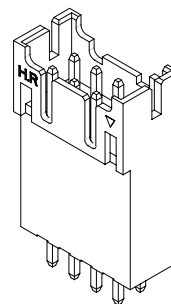

Dimensions:

Circuit No.	Dimensions	
	A	B
2X02	2.00	6.00
2X03	4.00	8.00
2X04	6.00	10.00
2X05	8.00	12.00
2X06	10.00	14.00
2X07	12.00	16.00
2X08	14.00	18.00
2X09	16.00	20.00
2X10	18.00	22.00
2X11	20.00	24.00
2X12	22.00	26.00
2X13	24.00	28.00
2X14	26.00	30.00
2X15	28.00	32.00
2X16	30.00	34.00
2X17	32.00	36.00
2X18	34.00	38.00
2X19	36.00	40.00
2X20	38.00	42.00
2X21	40.00	44.00
2X22	42.00	46.00
2X23	44.00	48.00
2X24	46.00	50.00

Unit:mm

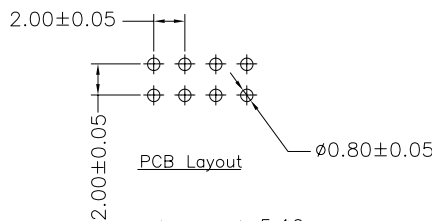
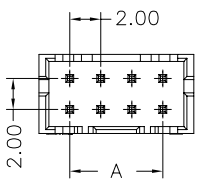

A2004WVC-2XNP X X X XX X XX X

① ② ③ ④ ⑤ ⑥ ⑦

- ① Halogen Free or Not
- ② Material
- ③ Color
- ④ Plating Code for Contacts
- ⑤ Plating Code
- ⑥ Option Code
- ⑦ Packing Code

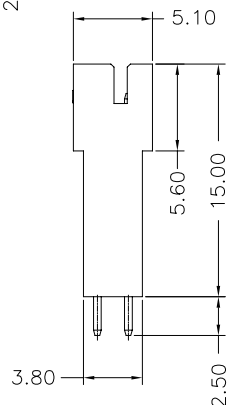
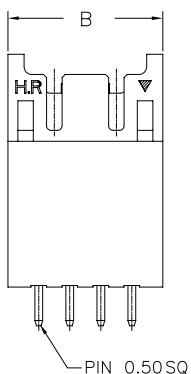

A  
B  
C  
F



# A2004 SERIES

2.00mm Pitch Wire to Board Connector

## A2004HD-2

2.00mm Pitch Dual Row Housing

### Reference Information:

- \*Material: Thermoplastic
- \*Suitable H.R A2004 Series Terminal
- \*Mates with H.R A2004WRD Series Dual Row Wafer

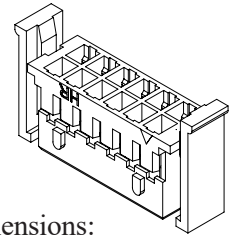

Dimensions:

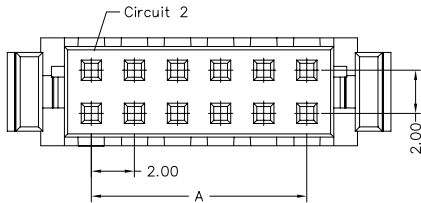

A2004HD-2XNP X X X XX X XX X  
① ② ③ ④ ⑤ ⑥ ⑦

- ① Halogen Free or Not
- ② Material
- ③ Color
- ④ Plating Code for Contacts
- ⑤ Plating Code
- ⑥ Option Code
- ⑦ Packing Code

Circuit No.	Dimensions	
	A	B
2X02	2.00	4.50
2X03	4.00	6.50
2X04	6.00	8.50
2X05	8.00	10.50
2X06	10.00	12.50
2X07	12.00	14.50
2X08	14.00	16.50
2X09	16.00	18.50
2X10	18.00	20.50
2X11	20.00	22.50
2X12	22.00	24.50
2X13	24.00	26.50
2X14	26.00	28.50
2X15	28.00	30.50
2X16	30.00	32.50
2X17	32.00	34.50
2X18	34.00	36.50
2X19	36.00	38.50
2X20	38.00	40.50
2X22	42.00	44.50

Unit:mm

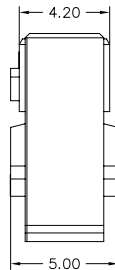
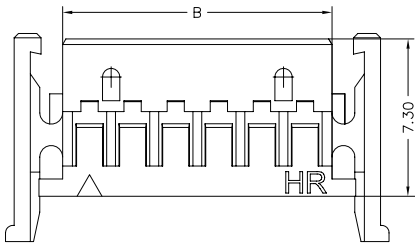

## A2004WRD-2

2.00mm Pitch 90° Dual Row Wafer

### Reference Information:

- \*Material: Pin: Copper Alloy  
Wafer: Thermoplastic
- \*Mates with H.R A2004HD Series Dual Row Housing

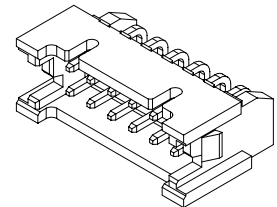

Dimensions:

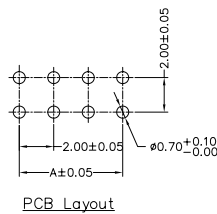
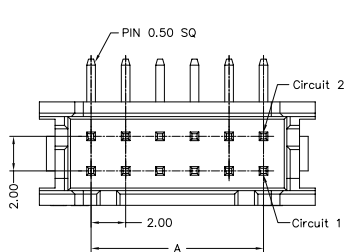

A2004WRD-2XNP X X X XX X XX X  
① ② ③ ④ ⑤ ⑥ ⑦

- ① Halogen Free or Not
- ② Material
- ③ Color
- ④ Plating Code for Contacts
- ⑤ Plating Code
- ⑥ Option Code
- ⑦ Packing Code

Circuit No.	Dimensions	
	A	B
2X02	2.00	8.00
2X03	4.00	10.00
2X04	6.00	12.00
2X05	8.00	14.00
2X06	10.00	16.00
2X07	12.00	18.00
2X08	14.00	20.00
2X09	16.00	22.00
2X10	18.00	24.00
2X11	20.00	26.00
2X12	22.00	28.00
2X13	24.00	30.00
2X14	26.00	32.00
2X15	28.00	34.00
2X16	30.00	36.00
2X17	32.00	38.00
2X18	34.00	40.00
2X19	36.00	42.00
2X20	38.00	44.00

Unit:mm

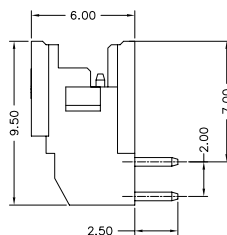
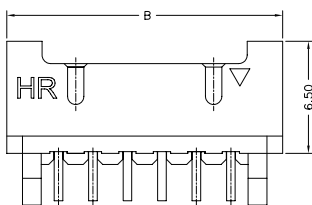

A  
B  
C  
F